



# FDLA's 28<sup>th</sup> Annual Florida Liability Claims Conference

June 18-20, 2025

## Disney's Yacht & Beach Club Resorts



© Disney



© Disney

CONFERENCE PROGRAM SPONSOR



Tampa  
Miami  
Orlando  
Pensacola  
Jacksonville  
Florida Keys  
Fort Lauderdale

**CLE. . .Networking. . .Pixie Dust. . .and more!**



**MATT LAVISKY**  
2025 FLCC Event Chair

# WELCOME

As Chair of the 28<sup>th</sup> Annual Florida Liability Claims Conference, I want to welcome you to *Disney's Yacht & Beach Club* Resorts. This year's event is bigger, better, and more magical than ever. We have an exciting lineup of presentations and speakers, along with numerous networking and social events. I hope you enjoy all we have planned for you!



## CONFERENCE AT A GLANCE

### WEDNESDAY, JUNE 18, 2025

3:00-5:00	FDLA Board Meeting	Saybrook Room
5:00-6:00	Past Presidents Meeting	Saybrook Room

### THURSDAY, JUNE 19, 2025

7:00-7:55	Registration/Full Breakfast - Exhibit Hall - <i>Sponsored by Explico</i>	Newport East
7:55-8:00	Opening Remarks	Newport West

### SESSIONS

8:00-9:00	Staying in the Game: The Power and Necessity of Resilience in Legal Practice	Newport West
9:00-10:00	Third Party Litigation Funding for Practitioners	Newport West
9:00-10:00	Comparing Perception Response Time to Average Drivers in Automobile Crashes	GH Salons 3-4
9:00-10:00	Intelligence Tradecraft: Principles for Advanced Investigations	Cape Cod Hall
10:00-10:15	Networking Break - Exhibit Hall - <i>Sponsored by Shadow Investigations</i>	Newport East
10:15-11:15	Claims from the Adjuster Perspective	Newport West
10:15-11:15	Defending the Ground: Strategies for Premises Liability Cases	GH Salons 3-4
10:15-11:15	Swipe Right on Evidence: Cellphone Forensics Without the Privacy Panic	Cape Cod Hall
11:15-12:15	2024-25 Insurance Defense Case Law Update	Newport West
11:15-12:15	The Theory and Practice of Using Statutory Interpleader to Resolve Auto Claims and Preclude Extracontractual Liability	GH Salons 3-4
11:15-12:15	Biomechanical Assessments in Vehicle Collisions from Low to High Speed	Cape Cod Hall
12:15-1:30	Lunch - Exhibit Hall - <i>Sponsored by Selective Investigations</i>	Newport East
1:30-2:00	Members Business Meeting & FDLA Awards	Newport West
2:00-3:00	Judicial Panel - The Doctrine of Stare Decisis: Its Scope and Limits	Newport West
3:00-3:15	Networking Break - Exhibit Hall - <i>Sponsored by Complex Legal Services</i>	Newport East
3:15-4:15	Understanding and Avoiding Legal Malpractice	Newport West
3:15-4:15	Emerging Issues in Bad Faith	GH Salons 3-4
3:15-4:15	A Proposal for Settlement for All Seasons: Effective Use of the PFS in Florida's New Legal Landscape	Cape Cod Hall
4:15-5:15	Pleading, Proof, and Preservation of Punitive Damages Claims: Tips for Florida Trial Lawyers and Appellate Attorneys	Newport West
4:15-5:15	Treating Physicians in Liability Lawsuits: Strategies for Managing Medical Testimony	GH Salons 3-4
4:15-5:15	Consumer Glass Products and Loss Investigations	Cape Cod Hall
5:30-7:00	Welcome Reception - <i>Sponsored by MKA International</i>	Atlantic Dance Hall



## FRIDAY, JUNE 20, 2025

7:00-8:30	Registration/Full Breakfast - Exhibit Hall - <i>Sponsored by J.S. Held</i>	Newport East
7:30-8:30	Character Meet & Greet	East Rotunda

## SESSIONS

8:30-9:30	Building Successful Teams: Assembling, Training, and Connecting with Associates	Newport West
8:30-9:30	Hurricane Claims: The Wind vs. Water Debate in Florida	GH Salons 3-4
8:30-9:30	Avoiding Major Mistakes with Minor Settlements	Cape Cod Hall
9:30-10:30	To Anchor or Not Anchor in the Nuclear Life Care Plan World	Newport West
9:30-10:30	Fluff Estimates and Common Disputes, "Errors," and Methods for Calculating the Cost of Damage	GH Salons 3-4
9:30-10:30	The Good, the Bad, and the Ugly: Where Good Claims Go Bad and How to Keep it From Getting Ugly! Ethics and Professionalism in Claims Adjusting and Litigation	Cape Cod Hall
10:30-10:45	Networking Break - <i>Sponsored by Vertex Engineering</i>	Newport East
10:45-11:45	How AI Can Help You Win at Trial	Newport West
10:45-11:45	Gone Phishing: Email Fraud Liability and Other Cyber Issues	GH Salons 3-4
10:45-11:45	Letters of Protection, Medical Funding, and Liens: Implications for Calculating Reasonable Value of Medical Losses	Cape Cod Hall
11:45-1:00	Lunch - Exhibit Hall - <i>Sponsored by Recon Response Engineering</i>	Newport East
1:00-2:00	Cracking the Code on Challenging Medical Bills in the Post-Tort Reform Era	Newport West
1:00-2:00	Removing on Up: Tips and Tricks for Removing Your Case to Federal Court—And Not Getting Remanded	GH Salons 3-4
2:00-3:00	The Do's & Don'ts For A Successful Jury Trial	Newport West



# CONFERENCE SCHEDULE

## THURSDAY, JUNE 19, 2025

**7:00-7:55 Registration and Full Breakfast** *Newport East*  
*Sponsored by Explico*

**7:55-8:00 Opening Remarks** *Newport West*

**8:00-9:00**

### **Staying in the Game: The Power and Necessity of Resilience in Legal Practice**

*Newport West*

Dr. Carrie Elk, *Founder*  
The Elk Institute for Psychological Health & Performance

Frank Pierce, IV, *Partner*  
Luks, Santaniello, Petrillo, Cohen & Peterfriend

Beth Scarola, *Member*  
Epstein Becker & Green, P.C.

This session explores the personal stories of two defense attorneys who overcame profound personal hardship, joined by Dr. Carrie Elk, a trauma and human performance expert, who offers science-backed strategies to foster resilience, preserve mental health, and sustain long-term success in the legal profession.

**9:00-10:00**

### **Third Party Litigation Funding for Practitioners**

*Newport West*

Danielle M. Waltz, *Assistant VP of Government Affairs  
and Associate General Counsel*  
West Virginia University Health System

This session will provide a comprehensive overview of third-party litigation funding (TPLF) and its growing impact on civil litigation and will explore the structure and mechanics of TPLF arrangements, including how funders evaluate cases, negotiate terms, and influence litigation strategy and also address key legal and ethical considerations for defense counsel.

### **Comparing Perception Response Time to Average Drivers in Automobile Crashes**

*GH Salons 3-4*

Jodie E. Immell, BSME, ACTAR, *Senior Engineer*  
Q Forensics

It is often helpful to understand whether someone responded in a timely manner to a crash. Published studies have been compiled, which can be utilized to compare a specific crash to the data. Crash Perception Response Times (PRT's) are differentiated by crash types and can be adjusted to match conditions that may have existed for the crash in question.

### **Intelligence Tradecraft: Principles for Advanced Investigations**

*Cape Cod Hall*

Bob Gordon, *General Manager*  
DigiStream Investigations

Jay Ochal, *Investigative Consultant*  
DigiStream Investigations

This session utilizes real world case examples to teach essential principles behind the methodology and technology of geosocial and geospatial investigations, device forensics, location tracking, video and imagery upscaling, international investigations, and complex surveillance operations. The session then describes how to leverage these capabilities to maximum effect in a legally robust manner. The audience will learn these advanced investigative solutions are far more accessible and affordable than they believe.

**10:00-10:15 Networking Break** *Newport East*  
*Sponsored by Shadow Investigations*

**10:15-11:15**

### **Claims from the Adjuster Perspective**

*Newport West*

William Peterfriend, *Managing Partner*  
Luks, Santaniello, Petrillo, Cohen & Peterfriend

Many attorneys, both at the partner and associate level, fail to fully appreciate the inner workings from the carrier perspective. This course will educate counsel of the obstacles and tools needed for claims handlers to evaluate claims for authority while educating claims handlers what counsel needs from them to ensure both sides work together most effectively.

### **Defending the Ground: Strategies for Premises Liability Cases**

*GH Salons 3-4*

Jason Anderson, P.E., *Sr. Civil Site Engineer*  
SEA, Ltd.

R. Ryan Rivas, *Partner*  
Hall Booth Smith, P.C.

This session will provide defense attorneys with practical approaches to navigate and mitigate the complexities of premises liability claims. This presentation explores defenses and features real-world case studies, showcasing advanced methods and analyses used in expert evaluations of premises liability.

### **Swipe Right on Evidence: Cellphone Forensics Without the Privacy Panic**

*Cape Cod Hall*

Lance Phy, *Accident Reconstructionist*  
Aperture

Matt Levan, *Digital Forensic Expert*  
Aperture

This presentation provides attorneys with a comprehensive overview of cellphone forensics for liability claims. Attendees will learn about acquisition methods, the critical role of data analysis, balancing privacy concerns, and the importance of rapid data preservation to secure valuable evidence.

# THURSDAY, JUNE 19, 2025

11:15-12:15

## 2024-25 Insurance Defense Case Law Update

### Newport West

Christy Earls, *Associate*  
Smith Bigman Brock, P.A.

Brooke Gaffney, *Of Counsel*  
Smith Bigman Brock, P.A.

Elizabeth Myers, *Partner*  
Smith Bigman Brock, P.A.

Kathleen Rogers, *Associate*  
Smith Bigman Brock, P.A.

An interactive presentation to review important cases related to insurance defense decided in the past year. Topics include tort reform, insurance and coverage, bad faith, torts, damages, and civil procedure.

## The Theory and Practice of Using Statutory Interpleader to Resolve Auto Claims and Preclude Extracontractual Liability

### GH Salons 3-4

David Krouk, *Partner*  
Butler Weihmuller Katz Craig, LLP

James Michael Shaw, Jr., *Partner*  
Butler Weihmuller Katz Craig, LLP

A new statutory-interpleader procedure was enacted as part of the 2023 tort reforms. Though facially straightforward, the procedure involves practical difficulties and traps for the unwary. We'll address practical considerations in its employment, defensive maneuvers to expect from claimant defendants, exposures created and eliminated by interpleader actions, and remaining uncertainties.

## Biomechanical Assessments in Vehicle Collisions from Low to High Speed

### Cape Cod Hall

Joe Pearson, Ph.D., *Biomechanics Senior Associate*  
Exponent

Sarah Sharpe, Ph.D., *Biomechanics Principal*  
Exponent

This presentation will discuss how biomechanical assessments of occupant motion and forces, injury mechanism and potential, and occupant restraint system interactions can be used to assess what did and didn't happen during a vehicle collision

12:15-1:30 **Lunch** **Newport East**  
*Sponsored by Selective Investigations*

1:30-2:00 **Members Business Meeting & FDIA Awards** **Newport West**

2:00-3:00

## Judicial Panel - The Doctrine of Stare Decisis: Its Scope and Limits

### Newport West

Hon. Kansas Gooden, *Judge*  
Third District Court of Appeal

Hon. Eric Netcher, *Circuit Judge*  
Ninth Judicial Circuit Court

Hon. James W. Sherman, *Circuit Judge*  
Fifteenth Judicial Circuit Court

Elaine Walter, *Partner*  
Kula & Associates, P.A.

Trial court judges very often express their concern with how civil trial lawyers use precedent in their written filings and arguments. This course is designed to provide insight from sitting judges – two trial court judges and one appellate judge – on what to look for in your cases by way of legal authority to use in your filings to better ensure success.

3:00-3:15 **Networking Break** **Newport East**  
*Sponsored by Compex Legal Services*

3:15-4:15

## Understanding and Avoiding Legal Malpractice

### Newport West

Michael Corso, *Partner*  
Henderson, Franklin, Starnes & Holt, P.A.

Jerry Olivo, *Partner*  
Henderson, Franklin, Starnes & Holt, P.A.

A comprehensive session aimed at equipping attendees with strategies to mitigate malpractice risks. Incorporating highlights from the latest ABA nationwide three-year study on legal malpractice claims, published in September/October 2024, the presentation provides fresh insights into key statistics, common errors, and emerging trends. Attendees will also explore Florida-specific legal standards and actionable best practices to safeguard client interests and maintain professional integrity.

## Emerging Issues in Bad Faith

### GH Salons 3-4

Neil Blackmon, *Counsel*  
Sandberg Phoenix

This session will discuss the impact of recent substantive changes to Florida bad faith law in light of the amendments to Florida Statute 624.155 and other related statutes. We will explore what these changes to Florida bad faith law mean for how we advise clients and evaluate how Florida courts are interpreting early cases arising under the amendments.

## A Proposal for Settlement for All Seasons: Effective Use of the PFS in Florida's New Legal Landscape

### Cape Cod Hall

Sean P. Greenwalt, *Associate*  
Marshall Dennehey

Amara B. Rodriguez, *Associate*  
Marshall Dennehey

This presentation will highlight the best methods to leverage the proposal for settlement in Florida's fast changing litigation environment due to tort reform, recent case law and the newly amended 2025 Florida Rules of Civil Procedure by accounting for new damage calculations, compressed case timelines, and defending proposal attacks.

4:15-5.15

## **Pleading, Proof, and Preservation of Punitive Damages Claims: Tips for Florida Trial Lawyers and Appellate Attorneys**

### ***Newport West***

Kimberly K. Berman, B.C.S., *Shareholder*  
Marshall Dennehey

Mihaela Cabulea, B.C.S., *Partner*  
Butler Weihmuller Katz Craig, LLP

William Linero, Jr., *Partner*  
Butler Weihmuller Katz Craig, LLP

This presentation focuses on the standard for leave to amend a pleading to assert a punitive damages claim as it has developed since Florida Rule of Appellate Procedure 9.130(a)(3) was amended in 2022 to allow for interlocutory appeals of orders granting or denying a motion for leave to amend to assert a claim for punitive damages. The objective is to give the attendees a good understanding of the split among the district courts of appeal on the quantum of proof a plaintiff must offer to be allowed to amend its pleadings to add a punitive damages claim. The presentation will enable practitioners to correctly navigate the different requirements in the court state system without waiving any viable arguments while the issue is still under review by the highest court of the state.

## **Treating Physicians in Liability Lawsuits: Strategies for Managing Medical Testimony**

### ***GH Salons 3-4***

Dr. Henry Harris Barnard, II, M.D., Orthopedic Surgeon  
Musculoskeletal Associates

Brandon A. Blake, *Partner*  
Bolin Law Group

Andrew Bolin, *Partner*  
Bolin Law Group

This session will provide a comprehensive exploration of the role of treating physicians in liability lawsuits. Attendees will gain insights into orthopedic injuries and surgical considerations common in personal injury cases, strategic approaches for handling treating physicians in depositions and trials, and motions to limit or exclude testimony. The session will include practical strategies and real-world examples to help defense attorneys effectively manage testimony from treating physicians.

## **Consumer Glass Products and Loss Investigations**

### ***Cape Cod Hall***

James Collins, Ph.D., *Materials Science and Engineering Expert*  
ARCCA, LLC

Glass is a material we use and interact with daily. Failure of drinkware, windows, shower glass, and automotive glass can lead to losses related to personal injury, property, or loss of life. This topic will cover the main categories of glass products and use case studies to explore losses.

# Welcome Reception

Sponsored by  
**MKA International**

**5:30 - 7:00 PM**  
**Atlantic Dance Hall**



© Disney

Join us for the  
installation of the  
2025-26  
Board of Directors

# FRIDAY, JUNE 20, 2025

**7:00-8:30 Registration and Full Breakfast** **Newport East**  
*Sponsored by J.S. Held*

**7:30-8:30 Character Meet and Greet** **Newport West**

**8:30-9:30**

## **Building Successful Teams: Assembling, Training, and Connecting with Associates**

### **Newport West**

Ian Ronderos, *Senior Partner*  
Walton Lantaff Schroeder & Carson LLP

Laz Rodriguez, *Senior Partner*  
Walton Lantaff Schroeder & Carson LLP

This presentation addresses building, training, and developing a successful team of associates. It provides attendees with the training and resources to transform a collection of associate attorneys into a true team dedicated towards the goals of high-quality legal work, successful results, and profitable & ethical billing.

## **Hurricane Claims: The Wind vs. Water Debate in Florida**

### **GH Salons 3-4**

Jonathan Williams, *PE, Partner*  
Grindley Williams Engineering

Tom Diana, *Co Founder*  
Zinober Diana & Monteverde P.A.

Focusing on disputes over wind versus water damage, the program combines legal frameworks, policy coverage, and case studies to aid attorneys in effectively navigating structural damage claims and litigation.

## **Avoiding Major Mistakes with Minor Settlements**

### **Cape Cod Hall**

Kimberly E. Lorenz, *Certified Circuit Civil Mediator, Minor Settlement & Litigation Counsel*

Lorenz Mediation

Don't let your minor settlements become major headaches: This course by defense litigator-turned- Certified Mediator Kimberly E. Lorenz addresses recent changes to the law as well as the various cases and statutes affecting minor settlements, and engages in a thorough analysis of the options and process for resolution. Learn why taking lead on these petitions gets your cases resolved sooner, alternatives to avoid formal guardianships, options for the minor's funds and common pitfalls to avoid.

**9:30-10:30**

## **To Anchor or Not Anchor in the Nuclear Life Care Plan World**

### **Newport West**

Ed Carbone, *Member*  
Burns White

Ashley Grzybowicz, *DNP, APRN, FNP-BC, CLCP, Life Care Planner*  
InQuis Global

Jud Woody, *General Counsel and Founder*  
InQuis Global

This presentation will focus on current trends in the life care planning profession around the country with special emphasis on new analysis under Daubert and Amended Rule 702 and whether to designate a life care planning expert in the defense of Florida cases.

## **Fluff Estimates and Common Disputes, "Errors," and Methods for Calculating the Cost of Damage**

### **GH Salons 3-4**

William Gutek, *Partner*  
Bronstein & Carmona

Paul R. Marsenison, *P.E., CGC, Construction Practice Leader*  
Rimkus

Michael R. Podolsky, *Partner*  
Bronstein & Carmona

This presentation will explain various current issues with property damage estimates including general, and detailed line by line assessment of how Plaintiffs might "fluff" their numbers to inflate their claimed damages.

## **The Good, the Bad, and the Ugly: Where Good Claims Go Bad and How to Keep it From Getting Ugly! Ethics and Professionalism in Claims Adjusting and Litigation**

### **Cape Cod Hall**

Katelyn Ferry, *Partner*  
Cambo Ferry, PLLC

Jon Pruitt, *Founder/President*  
Addison Riley, LLC: Forensics, Appraisal, Construction

Jim Shea, *Mediator*  
Miles Mediation & Arbitration

This presentation will discuss the claims process from inception through trial, and it will analyze countless ways that the claim can go wrong throughout that process. We will discuss errors and unscrupulous behaviors and tactics that we have seen at each phase of the process, and how simple corrections could have prevented years of contention and litigation.

**10:30-10:45 Networking Break** **Newport East**  
*Sponsored by Vertex Engineering*

**10:45-11:45**

## **How AI Can Help You Win at Trial**

### **Newport West**

Frank Ramos, *Partner*  
Goldberg Segalla

Frank will discuss how he uses AI to prepare for trial. Often we defense lawyers have to make the most with less time as we juggle multiple trial calendars. AI can help us prepare faster and better.

## **Gone Phishing: Email Fraud Liability and Other Cyber Issues**

### **GH Salons 3-4**

Nicole Fluet, *Director*  
Galloway

Mark Lehman, *Director*  
Galloway

We all see email scams on a regular basis, but what happens when a scam is successful? This presentation will look at the liability issues associated with monetary implications of compromised emails in Florida, along with touching on insurance coverage issues and considerations related to cyber security breaches.

# FRIDAY, JUNE 20, 2025

## Letters of Protection, Medical Funding, and Liens: Implications for Calculating Reasonable Value of Medical Losses

### Cape Cod Hall

Jennifer A. Hoffman, *Shareholder*  
Carr Allison

Francesca Naumann, *Associate*  
Thompson Miller

Cara Scheibling, *VP & Principal*  
Avalon Health Economics

John E. Schneider, PhD, *CEO & Principal*  
Avalon Health Economics

Medical costs are increasingly funneled through “Letters of Protection,” or LOPs, “Medical Funding,” and liens. Generally, these techniques are designed to increase charged amounts and prevent bills from being paid by third parties. In the post-tort reform era in Florida, it is likely that these techniques will become more prevalent as claimants seek means of mitigating tort reform and maximizing medical losses. The key to countering cases with LOPs and other obstructions is a clear understanding of the fair market and reasonable value of the medical expenses.

**11:45-1:00 Lunch** *Newport East*  
*Sponsored by Recon Response Engineering*

**1:00-2:00**

## Cracking the Code on Challenging Medical Bills in the Post-Tort Reform Era

### Newport West

Laurette Balinsky, *Senior Partner*  
Luks, Santaniello, Petrillo, Cohen & Peterfreund

Toni Elhoms, CCS, CPC, CPMA, CRC, CEMA, *Medical Billing Expert*  
AccuMed

Phil Wiseberg, *Shareholder*  
Kubicki Draper

It is no secret that the cost of medical treatment in personal injury cases has skyrocketed. Understanding the technical factors driving these escalating costs is essential to navigating medical billing disputes and resolving more cases. Healthcare Providers often violate billing and coding rules and artificially inflate charges, which results in highly inflated medical bills. This interactive panel discussion will dissect current trends in litigation from both an attorney and medical billing and coding expert's perspective, share lessons learned from recent depositions/trials, and discuss judicial interpretations and recent court orders addressing the post-tort reform rules.

## Removing on Up: Tips and Tricks for Removing Your Case to Federal Court—And Not Getting Remanded

### GH Salons 3-4

Petra Justice, *Shareholder*  
Banker Lopez Gassler

This presentation is designed to give the audience a refresher on the basics of removing a case to federal court based on diversity jurisdiction, while learning tips on how to remove even the trickiest of cases and avoid getting remanded.

**2:00-3:00**

## The Do's & Don'ts For A Successful Jury Trial

### Newport West

Ricardo Luces, *Partner*  
Roig Lawyers

The objective of this presentation is to identify proven strategies to use and pitfalls to avoid when preparing for and participating in a jury trial.

## CLE and CE Information 2025 Florida Liability Claims Conference

### Florida Bar Approval

#### Course Number:

2506398N

#### Level:

Intermediate

#### CLE Credits

General: 14.5

Mental Health and Wellness: 1.0

Ethics: 2.5

Technology: 2.5

#### Certification Credits

Civil Trial: 14.5

## Florida Department of Financial Services Approval

2025 Florida Liability Claims Conference (3-24a)

Course Authority: CE 3-24a – Law and Policy

Course ID: 134255

Course Offering: 1220654

2025 Florida Liability Claims Conference (3-24c)

Course Authority: CE 3-24c – Adjuster Optional

Course ID: 134256

Course Offering: 1220632

Max Total Hours: 12



# MEET OUR SPONSORS and EXHIBITORS

## **Abacus Analytics**

Jeffrey Craig - [Jeff@medicalcostexperts.com](mailto:Jeff@medicalcostexperts.com)  
<https://medicalcostexperts.com>

Abacus Analytics medical billing experts have 15+ years of experience in healthcare finance and can provide deposition and trial testimony on the reasonableness of past and future medical expenses. Data Includes 120% Medicare, Health Insurance Reimbursement Rates, and Usual, Customary and Reasonable (UCR) Rates.

## **AccuMed**

Sean Duncan - [sean.duncan@accumedintel.com](mailto:sean.duncan@accumedintel.com)  
<https://www.accumedintel.com>

AccuMed provides attorneys with data on what local providers and facilities charge within a 30 mile radius of the client. We have a highly credentialed and local Medical Billing and Coding Expert that can opine to fraudulent coding tactics and inflated medical bills.

## **Addison Riley**

Jon Pruitt - [jpruitt@addisonriley.com](mailto:jpruitt@addisonriley.com)  
<https://addisonriley.com>

Addison Riley, LLC is an appraisal, forensic, and construction company servicing the majority of the nation. Their reputation of integrity has earned them mutual trust on both sides of the isle. From window and air testing, to cost/scope, engineering, and meteorology; reports with an AR logo are trusted.

## **Aperture**

Chad Smith - [chad.smith@aperturellc.com](mailto:chad.smith@aperturellc.com)  
<https://www.aperturellc.com>

As a national portfolio of premier forensic services companies, Aperture uses proven science and accepted industry standards to deliver accurate and efficient expert analysis. Our services include Accident Reconstruction, Premises Liability, Biomechanics, Construction Consulting, Digital Forensics, Economic Damages and more. We leave nothing unturned, unanalyzed, or unexplained.

## **ARCCA - FDLA Silver Annual Sponsor**

Sioux Klinsky - [dwirth@arcca.com](mailto:dwirth@arcca.com)  
<https://arcca.com>

For more than 30 years, ARCCA has been providing expert forensic, scientific and engineering solutions to its clients, and our team of experts can help with all phases of investigation: from initial file review and triage, inspections and testing, report/affidavit/disclosure preparation, evidence preservation, and exhibit preparation and trial testimony.

## **Avalon Health Economics - FDLA Gold Annual Sponsor**

Cara Scheibling - [cara.scheibling@avalonecon.com](mailto:cara.scheibling@avalonecon.com)  
<https://avalonecon.com>

Avalon Health Economics is a team of academic and industry health economics and outcomes researchers providing high quality, high value real-world health economics and outcomes research consulting.

## **Beytin McLaughlin**

Lori Hutchens - [lh@law-fla.com](mailto:lh@law-fla.com)  
<https://law-fla.com>

Beytin McLaughlin is a full-service civil defense law firm and has been dedicated to defending the rights of health care providers, health care practices and hospitals throughout the State of Florida over the last 20 years. We successfully defend our clients in both State and Federal Courts with practice areas encompassing medical negligence, professional negligence, general negligence, commercial litigation, administrative law, appellate law, health care law, health care transactions and alternative dispute resolution.

## **Bickford & Chidnese, LLP**

Eric Nelsestuen - [eric@bcflalaw.com](mailto:eric@bcflalaw.com)  
<https://bcflalaw.com>

In addition to representing Florida's insurance carriers, we provide general commercial litigation services to Florida businesses including commercial landlords and technology firms. With our long experience on both sides of the inside and outside counsel relationship, Bickford & Chidnese litigates to achieve results, not run up fees. Allow us to show you that difficult problems don't always have difficult solutions.

## **Bolin Law Group**

Andy Bolin - [asb@bolin-law.com](mailto:asb@bolin-law.com)  
<https://bolin-law.com>

Our clients face extraordinary challenges. They often operate in highly regulated industries and are increasingly subjected to expensive claims and litigation. BLG is dedicated to meeting those challenges, achieving the goals of those we represent and promoting a level playing field in civil lawsuits.

## **BRC - FDLA Bronze Annual Sponsor**

Jason Manley - [jmanley@brconline.com](mailto:jmanley@brconline.com)  
<https://brconline.com>

BRC specializes in biomechanical analysis and accident reconstruction to include both high and low-velocity vehicle collisions, slip, trip and fall events, injuries associated with aircraft, bicycles, motorcycles, ATVs, boats, elevators, escalators, forklifts, tractor-trailers, trains, amusement park rides, trampolines, power tools, light industrial equipment, sports and exercise equipment. BRC consultants include physicians, most of whom also have engineering degrees, and consultants with a PhD in engineering.

## **Burns White LLC**

Jennifer Kelly - [jkelly@burnswhite.com](mailto:jkelly@burnswhite.com)  
<https://burnswhite.com>

Burns White is a leading litigation law firm providing comprehensive litigation and corporate counsel services to clients from a broad spectrum of industries nationwide. Harnessing the collective skill of more than 160 attorneys, the law firm operates fourteen locations in Delaware, Florida, Ohio, New Jersey, New York, Pennsylvania, and West Virginia.

## **Butler Weihmuller Katz Craig**

Matt Lavisky - [mlavisky@butler.legal](mailto:mlavisky@butler.legal)  
<https://www.butler.legal>

Butler is a civil litigation firm whose practice is devoted entirely to defense and insurance litigation. Our clients are corporations, insurance companies, and insured individuals, taking us across the North American continent, Europe and the Caribbean in order to provide the highest quality counsel.

## **CED Technologies**

Pete McCawley - [pmccawley@cedtechnologies.com](mailto:pmccawley@cedtechnologies.com)  
<https://www.cedtechnologies.com>

CED Technologies is a forensic engineering expert witness company that has been supporting FDLA and FLCC for over 20 years. With three Florida billing locations (Ft. Lauderdale, Tampa, Jacksonville) and nearly 20 Florida licensed engineers and contractors, CED has experienced experts to assist with premises cases, product cases, accident reconstructions, fire cases, construction defect cases, and property loss cases.

## **Complex Legal Services**

Jessica Wozniak - [jessica.wozniak@compexlegal.com](mailto:jessica.wozniak@compexlegal.com)  
<https://www.compexlegal.com>

Complex is the industry's most innovative record retrieval provider with a nationwide reach and a best-in-class client success approach. Our value-added services – Medical Summarization, Medical Canvassing, Social Media Canvassing, and Court Reporting – equip clients with deeper insights and stronger outcomes.

### **DDA Forensics - FDLA Bronze Annual Sponsor**

Jamey Bennett - jamey@ddaforensics.com  
<https://www.ddaforensics.com>

DDA Forensics is a forensic engineering and building consulting company for the insurance and legal industries. We specialize in evaluating and determining the cause of particular damages and failures for both residential and commercial structures throughout Alabama, Florida, Georgia, Louisiana, Mississippi, South Carolina, and Texas. Our team of experts have decades of combined experience in dealing with claims and construction-related litigation. We understand that clear, concise, and conclusive determinations are critical to any investigation.

### **DigiStream**

Bob Gordon - bgordon@digistream.com  
<https://digistream.com/>

DigiStream is the premiere provider of investigative services in the insurance defense market. We collect and organize evidence in the field and online that self-insured entities and legal professionals leverage to mitigate risk.

### **DLE Legal**

Roy De La Espriella - roy@dlelegal.com  
<https://dlelegal.com>

Originally a process server in Miami, DLE Legal has been serving legal documents for over a decade. Because of our continued support of some of South Florida's top law firms and their continued trust in our servers, we have grown to offer Process Serving, Court Reporting, Medical Document Retrieval, Videography, Interpreters and Translators, and Conference Room services throughout Florida and the United States.

### **Dutton Law Group**

Scott Dutton - sdutton@duttonlawgroup.com  
<https://duttonlawgroup.com>

Dutton Law Group offers comprehensive insurance coverage and defense services, including policy analysis and interpretation, and defense against claim litigation. The Firm also specializes in the handling and litigation of extra-contractual or bad faith issues, providing quality representation by legal professionals with significant experience in each area of practice.

### **ESi - FDLA Silver Annual Sponsor**

Heather Slatton - hslatton@engsys.com  
<https://www.engsys.com>

ESi is a full-service engineering investigation and consulting firm with locations coast-to-coast, serving clients across a global footprint. With state-of-the-art facilities and highly qualified professionals in almost every discipline, ESi is well-equipped to help clients with their most challenging technical issues.

### **Estes, Ingram, Foels & Gibbs, P.A.**

Julie Brodis - jhb@eifg-law.com  
<https://eifg-law.com>

Estes, Ingram, Foels & Gibbs, P.A. is engaged in a general litigation practice consisting almost entirely of the defense of healthcare professionals in civil litigation & administrative actions throughout the state. Our litigation staff consists of nine trial attorneys, litigation paralegals and legal nurse consultants. Each of the firm's members has been practicing general civil defense work for the entirety of their legal careers. J. Charles Ingram, Craig Foels, Eric Gibbs, Julie Brodis, Clayton Williams, Christian Trowbridge, and Dinelia Concepcion are all AV Preeminent rated by Martindale Hubbell.

### **Explico**

Meryl Coleman - mcoleman@explico.com  
<https://www.explico.com>

Explico delivers premium scientific and engineering services in accident reconstruction, biomechanics, human factors, and visualization, including railroad, fire & explosion, mechanical failure analysis, and marine accident reconstruction. We analyze evidence using industry accepted tools and techniques combined with state-of-the-art technology with a goal of conveying our findings in simple, concise terms.

### **Exponent - FDLA Gold Annual Sponsor**

Christopher Duniak - cduniak@exponent.com  
<https://www.exponent.com>

Exponent, Inc. is a leading engineering and scientific consulting firm known for assisting corporations, insurance carriers, government agencies, law firms and individuals by analyzing accidents and failures to determine their causes. Additionally, Exponent assists clients with new product development and process optimization to help prevent problems in the future.

### **FCG Associates - FDLA Bronze Annual Sponsor**

Jennifer Leo - jleo@fcgassociates.com  
<https://www.fcgassociates.com>

FCG Associates LLC (FCGA) is a team of senior professionals specializing in forensic engineering with a primary focus on property damage assessments. Our investigations range from everyday occurrences to responding to major catastrophic events such as hurricanes, tornadoes, hailstorms, floods, earthquakes, and ice storms. Whether the property is a small residential home or a large commercial building, our licensed professional engineers have examined thousands of property structures over the years providing timely and unbiased reports.

### **Forcon - FDLA Bronze Annual Sponsor**

Bryan Hubert - bhubert@forcon.com  
<https://forcon.com>

Celebrating 40 years of expertise, Forcon International provides forensic engineering, building consulting, surety, and fidelity services. With over 100 Forcon experts in nearly all fields, we have the right expert for your case. Based in Tampa, FL, we have experts throughout FL, the East coast and gulf coast.

### **Grindley Williams Engineering - FDLA Bronze Annual Sponsor**

Sarah Rohanna - srohanna@grindleywilliams.com  
<https://www.grindleywilliams.com>

Grindley Williams is a Florida-based consulting firm with a foundation of talented professional engineers who bring expertise from a wide range of sectors and backgrounds specializing in forensic engineering services. We offer structural engineering, mechanical, electrical, plumbing, geotechnical, expert witness, and construction defect services. With over 18,000 evaluations performed for commercial and residential properties, Grindley Williams provides the utmost expertise, efficiency, and precision for your engineering needs.

### **Henderson Franklin**

Gail Lamarche - gail.lamarche@henlaw.com  
<https://www.henlaw.com>

Founded in 1924, Henderson, Franklin, Starnes & Holt, P.A. is one of the largest and most experienced full-service law firms between Tampa and Miami. With over 55 attorneys who live, work and have deep roots in Southwest Florida, Henderson Franklin provides high quality, personalized legal services to a roster of corporate and individual clients.

### **IMS Legal - FDLA Gold Annual Sponsor**

Kyle Fridley - kfridley@imslegal.com  
<https://imslegal.com>

IMS Legal provides physicians/expert witnesses for record reviews, CMEs, billing/coding cost analysis, and more. IMS has 120+ experts in Florida. IMS has a case management team that assists experts with the administrative aspects of cases. They also provide Indexing of Records to save experts valuable time in the review process.

### **InQuis Global - FDLA Platinum Annual Sponsor**

Jud Wooddy - jwooddy@inquisglobal.com  
<https://inquisglobal.com>

InQuis is a forensic expert witness and litigation consulting firm specializing in life care planning and vocational rehabilitation/wage loss analysis. Our experts practice in both Federal and State Courts throughout the United States and specialize in personal injury, medical malpractice, products liability, premises liability and workers compensation cases.

### **International Sureties**

Conway Marshall - cmarshall@internationalsureties.com  
<https://www.internationalsureties.com>

International Sureties provides Appeal Bonds in all 50 states with exceptional terms and rates based on the company's experience as an industry leader since 1972. Significant in-house authority allows our Court bonds team to respond quickly and with certainty, and we are happy to discuss any potential needs to provide feedback to lawyers, insurance carriers, and others who wish to inquire about a particular need.

### **J.S. Held**

Cody McNair - cmcnair@jsheld.com  
<https://www.jsheld.com>

J.S. Held is a global consulting firm providing technical, scientific, and financial expertise across all assets and value at risk. J.S. Held provides a comprehensive suite of services, products, and data that enable clients to navigate complex, contentious, and often catastrophic situations. We have a team of 115 accident reconstruction experts across North America with expertise in human factors & driver behavior, forensic injury biomechanics, forensic animation & visualization, slip, trip & falls, product failure, and other non-motor vehicle accident personal injury investigations.

### **LCS Records Retrieval**

Nate Kadau - nkadau@teamlcs.com  
<https://legalcopyservices.com>

LCS Record Retrieval ensures a personalized experience catered to your specific needs. Our user-friendly Client Portal simplifies request submissions, status checks, accessing and sharing records, including diagnostic images. Utilize SimplySummarize© to receive fact-based summaries, including hyperlinks and bookmarks for chronological record navigation. Experience the LCS difference today!

### **Lorenz Mediation**

Kimberly E. Lorenz - Kimberly@LorenzMediation.com  
<https://lorenzmediation.com>

Lorenz Mediation features former FDLA member and trial attorney Kimberly Lorenz serving as a Florida Supreme Court Certified Mediator. Her versatility and experience allow her to be effective in even the most difficult cases, and her quick availability and success rate have her on the approved list of 30+ carriers.

### **MAZE Resolutions**

Sarah Zabel - sz@mazereresolutions.com  
<https://mazereresolutions.com>

MAZE Resolutions offers ADR services. The practice focuses on arbitration, mediation, private judging, and special magistrate. We look forward to helping you navigate through the maze of the court system and facilitating your case to a healthy conclusion.

### **MDD Forensic Accountants**

Kristine Elkind - kelkind@mdd.com  
<https://www.mdd.com>

MDD's Forensic Accountants have extensive experience working with CGL insurers and lawyers to evaluate claims that arise out of third-party coverages. Our team uses their economic damage quantification expertise to provide clients with the information they need to make informed decisions. For more information, please contact Kristine Elkind at 407.531.1050 or kelkind@mdd.com.

### **Miller Biomechanical Forensics - FDLA Bronze Annual Sponsor**

Dr. H. John Miller - millerbiomech@gmail.com  
<https://www.millerforensics.com>

Miller Biomechanical Forensics offers Biomedical, Mechanical, and Manufacturing Engineering services in the areas of crashworthiness, occupant safety, injury causation, product design, and manufacturing processes. Dr. Miller holds 35 patents and has several peer reviewed publications in the safety and occupant injury field.

### **MKA International**

Bill Holt - wholt@mkainc.com  
<https://www.mkainc.com>

MKA International, Inc. (MKA) is a leading multidisciplinary Construction & Engineering Consulting firm. Our forensic experts and construction professionals assist with litigated matters involving defective design, material, and construction deficiencies. Typical construction defect and litigation projects involve developer and contractor defense for residential subdivisions, multi-family residential, civil infrastructure, office and commercial development, and municipal facilities.

### **Paz Mediation**

Natalie Paskiewicz - natalie@pazmediation.com  
<https://www.pazmediation.com>

Natalie Paskiewicz, Esq., founded Paz Mediation in 2016 and has since conducted over 1000 mediations. Natalie is a certified circuit civil mediator and Florida Qualified Arbitrator based in the Tampa Bay area. Prior to starting Paz Mediation, Natalie practiced throughout the state of Florida in civil trial liability matters arising from premises liability, automobile negligence, products liability, first and third-party property claims, catastrophic injury, negligent security, and many areas in which she now mediates.

### **Quality Forensic Engineering, LLC**

Iola Goeke - igoeke@qforensics.com  
<https://qforensics.com>

Quality Forensic Engineering, LLC is a full-service forensic engineering firm, providing engineering support to clients in the areas of accident reconstruction, biomechanics, fire investigations, patent litigation analysis, premises liability, product liability, and tire failure analysis. We use the latest technology and industry proven techniques to provide thorough analysis, expert testimony, and conclusions for the most difficult engineering questions. Our forensic engineers support clients throughout the U.S.

### **Recon Response Engineering**

Amanda DeCort - amanda@reconresponse.com  
<https://reconresponse.com>

Recon Response Engineering has specialized in Florida construction defect cases since 2015. We handle roofing, water intrusion, stucco, balconies, and site grading litigation. Our founder, Andrew Schrader, is a Florida Board-Recognized Structural Engineer (FRSE) and serves as a first responder for the State of Florida's Urban Search and Rescue Task Force.

### **Rimkus - FDLA Bronze Annual Sponsor**

Ashley Henderson - ashley.henderson@rimkus.com  
<https://rimkus.com>

Rimkus is a worldwide provider of forensic consulting services to insurance companies, law firms, corporations and government agencies. Rimkus assists clients in the responsive and timely resolution of claims and disputes. The company's team of professional engineers, scientists, and technical specialists is recognized for its commitment to service excellence by local, national and international business communities.

### **Robson Forensic - FDLA Bronze Annual Sponsor**

Robbie Widlansky - rwidlansky@robsonforensic.com  
<https://www.robsonforensic.com>

Robson Forensic is a national leader in expert witness consulting, providing technical expertise across many fields within engineering, architecture, science, and a broad range of specialty disciplines. With offices in Miami and Palm Beach Gardens, we offer FDLA members local access to exceptionally qualified experts and state of the art forensic resources.

### **SEA, Ltd. - FDLA Platinum Annual Sponsor**

Alexa Capps - acapps@SEALimited.com  
<https://sealimited.com>

Since 1970, SEA is a forensic engineering company specializing in failure analysis. From our 11 offices our 180 full-time testify experts investigate losses which include the following components; metallurgy, electrical, mechanical, accident reconstruction, construction defect, marine, fire/explosion, slip/trip and fall, workplace safety, plus steam damage.

### **Seaside Claims - FDLA Platinum Annual Sponsor**

Matt Igou - migou@seasideclaims.com  
<https://seasideclaims.com>

Seaside Claims Services, LLC was launched in 2010 by our founder and CEO, Matt Igou. Mr. Igou is a U.S. Marine Corps veteran and Jacksonville native. Seaside Claims is based in Jacksonville, FL and conducts investigative services throughout GA, FL and the Caribbean islands. We are committed to personalized risk management solutions through creative investigation techniques and detailed adjusting services. Visit our website at [www.seasideclaims.com](http://www.seasideclaims.com) for more information.

### **Segal McCambridge Singer & Mahoney**

Jennifer O'Donnell - jodonnell@smsm.com  
<https://www.segalmccambridge.com/>

Segal McCambridge has built a reputation as a national law firm of accomplished trial attorneys for almost four decades. From 18 offices nationwide, the firm routinely counsels and defends clients, including Fortune 500 companies and corporations in complex litigation matters spanning product liability, insurance, employment, and more.

### **Selective Investigations, Inc**

Joelle Schwenk Cheeseman -  
jmschwenk@selectiveinvestigations.com  
<https://selectiveinvestigations.com>

Selective Investigations, Inc. is a fully licensed and insured private investigative agency specializing in insurance claims investigations established in 2002. We are a statewide agency that distinguishes ourselves from competitors by keeping a clear focus on customer service, and consistent high quality investigations. Our mission is to deliver outstanding service, combined with timely and accurate communication, and an ethical, thorough investigation to assist in the handling of your claims. Our investigators are fully trained, experienced and specialized.

### **Shadow Investigations**

Andrea Jones - Andreaj@shadowweb.us  
<https://shadowinvestigations.com>

Shadow Investigations is a trusted, full-service PI firm with 35 years of experience. We specialize in surveillance, background checks, social media investigations, and more - delivering fast, professional results tailored to our client's needs. Licensed in Florida and several other states, we're a proven, reliable investigative partner.

### **S.K.I. Investigations**

Rob Murphy - rmurphy@skiinv.com  
<https://skiinv.com>

S.K.I. Investigations is a nationwide, boutique-style investigative firm in business for 25 years. We serve major Carriers, defense firms, self-insureds, and TPAs, delivering customized, high-quality service. Our success is driven by exceptional communication, and attention to detail while meeting client needs in insurance-related investigations.

### **Smith Bigman Brock**

Cathi Robinson - crobison@daytonalaw.com  
<https://www.daytonalaw.com>

For more than a quarter-century, individuals, families and business clients in need of highly qualified legal counsel have turned with confidence to the respected firm of Smith Bigman Brock. Our standards for personalized, attentive service and difference-making representation remain higher than ever.

### **Vertex**

Catherine Pierce - cpierce@vertexeng.com  
<https://vertexeng.com>

The Vertex Companies is a global professional services and expert witness firm. Our multi-disciplined services in forensics and investigations, expert witness, project advisory, compliance, and regulatory consulting are unique and valued for the turnkey solutions and 360-degree perspective that we can bring. Areas of expertise include construction, environmental, industrial hygiene, accounting, engineering, and more.

### **Walton Lantaff Schroeder & Carson LLP**

Ian Ronderos - ironderos@waltonlantaff.com  
<https://www.waltonlantaff.com>

Established in 1934, Walton Lantaff Schroeder & Carson LLP is a full-service law firm representing large and small businesses, insurance carriers, financial institutions and individuals throughout Florida and across the country. We are an experienced team of lawyers who work closely with our clients to develop strategic solutions that resolve challenging legal problems.



# Conference Center Map

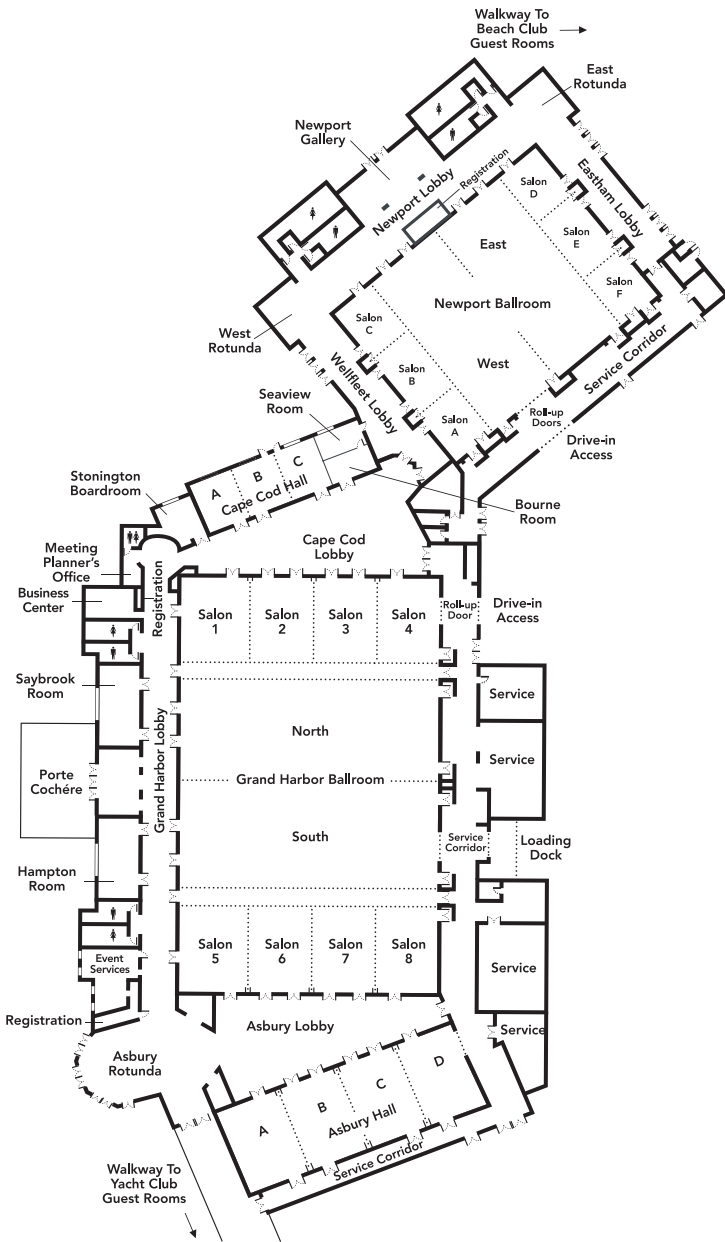

# HELP NOW

SAFETY. EMPOWERMENT. HEALING.

# FLA

FLORIDA DEFENSE LAWYERS ASSOCIATION

## FLORIDA LIABILITY CLAIMS CONFERENCE SUPPLY DRIVE 2025

HELP NOW OF OSCEOLA PROVIDES SAFETY, HEALING AND SUPPORT FOR DOMESTIC VIOLENCE SURVIVORS, OFFERING SHELTER AND EMPOWERING THEM TO LIVE FREE FROM ABUSE WHILE PROMOTING SOCIAL CHANGE

### MONETARY DONATION



HELP NOW

### SHELTER WISH LIST



HELP NOW OF OSCEOLA, INC.  
P.O. BOX 420370  
KISSIMMEE, FLORIDA 34742  
[WWW.HELPNOWSHELTER.ORG](http://WWW.HELPNOWSHELTER.ORG)

Platinum Sponsors



**InQuis**



Gold Sponsors



AVALON HEALTH ECONOMICS

**Exponent**



LEGAL STRATEGIES

Silver Sponsors



Experts in Forensic, Scientific  
& Engineering Solutions



Bronze Sponsors



**THE EXPERTS  
Robson Forensic**



Additional Exhibitors



**MAZE RESOLUTIONS PA**





# Thank You to Our Event Sponsors!



## Diamond Firm Sponsors



## Gold Firm Sponsors



## Silver Firm Sponsor



## Bronze Firm Sponsors





## Upcoming Events

**2025 Florida Insurance Network Symposium (FINS)**  
**August 14-15 2025**  
**Renaissance Tampa International Plaza**  
**Tampa, FL**

